

5443
11 of 11

WATERWAY

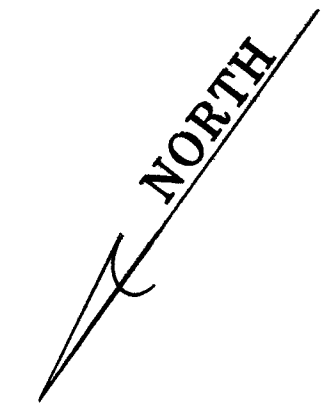
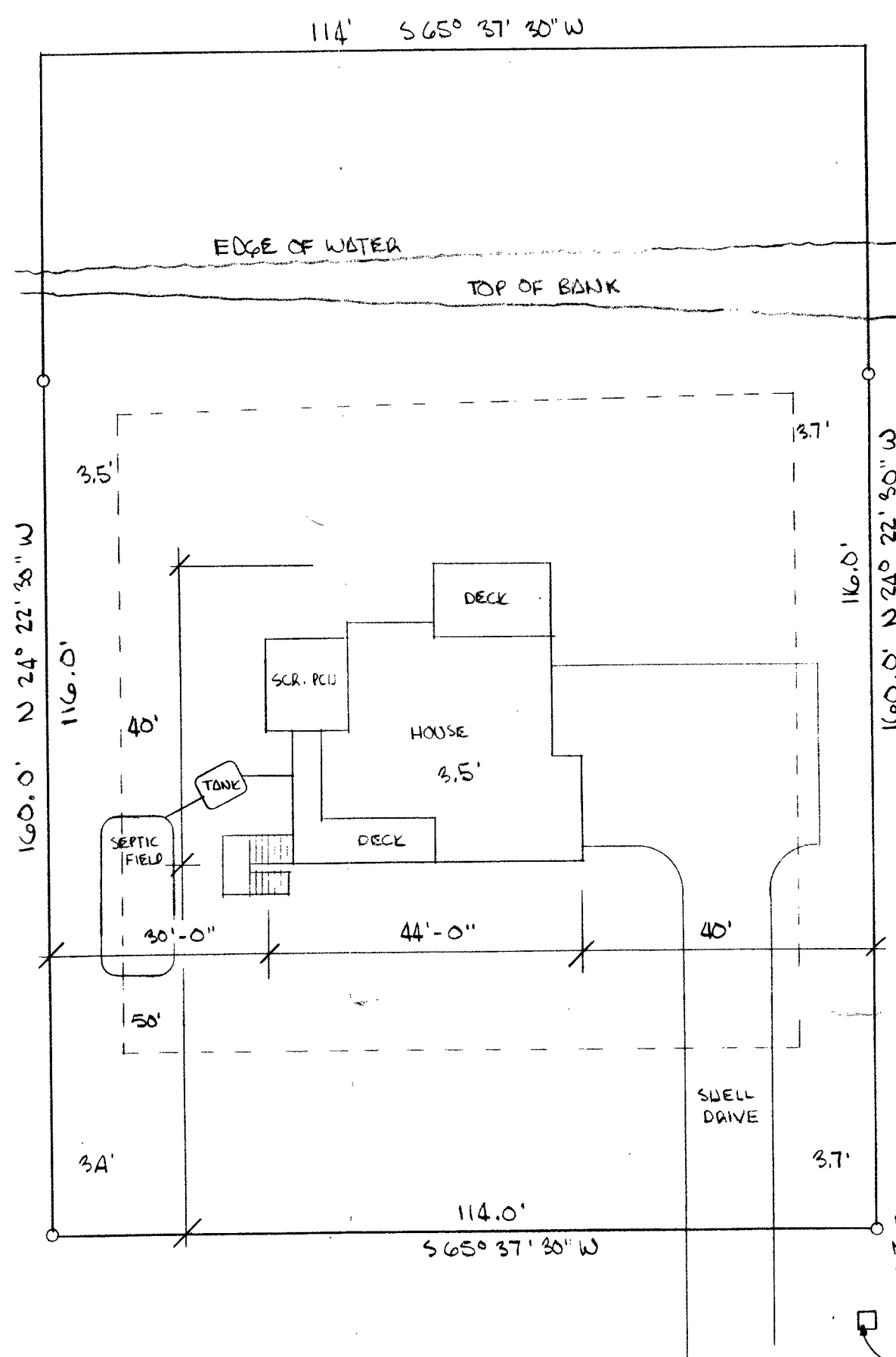

SURVEY PLAT FOR LOT 13 AND WEST 14 FEET OF LOT 12, BLOCK 5, SANIBEL ESTATES, UNIT NO. 1, A SUBDIVISION IN SECTIONS 20 & 21, T-46-S, R-23-E, AS RECORDED IN PLAT BOOK 9, PAGE 115, PUBLIC RECORDS OF LEE COUNTY, FLORIDA.

SITE AREA 15,000 ±
HOUSE, ETC. ±
COVERAGE 90

LAGOON DRIVE

VEGETATION NOTE:
This lot is densely vegetated. Since staking is not feasible, our superintendent would like to meet with a member of the vegetation committee to discuss vegetation removal and relocation. (Bill returns from vacation October 21).

SANIBEL HOMES
A RESIDENCE FOR
MR. & MRS. McGUIRE
TURU ATC# JOB# 593
1/