

HYDRO-STATIC VENT CALCS.
 GROUND FLOOR AREA.....
 2,440 SQ. FT. / 128 SQ. IN. = 19 VENTS

Revisions	
1	12 / 1 / 16
2	12 / 20 / 16
3	1 / 14 / 17
4	5/11/17

Job Number
 Date 11 / 1 / 16
 Drawn By J.C.
 Checked By
 Drawing Scale AS NOTED

STUDIO

DESIGN
 2223 MC OREGON BLVD.
 FT. MYERS, FLORIDA 33901
 (239) 707-9385

PROJECT:
THE MONAHAN RESIDENCE
 2411 BLUE CRAB COURT
 SANIBEL ISLAND, FLORIDA

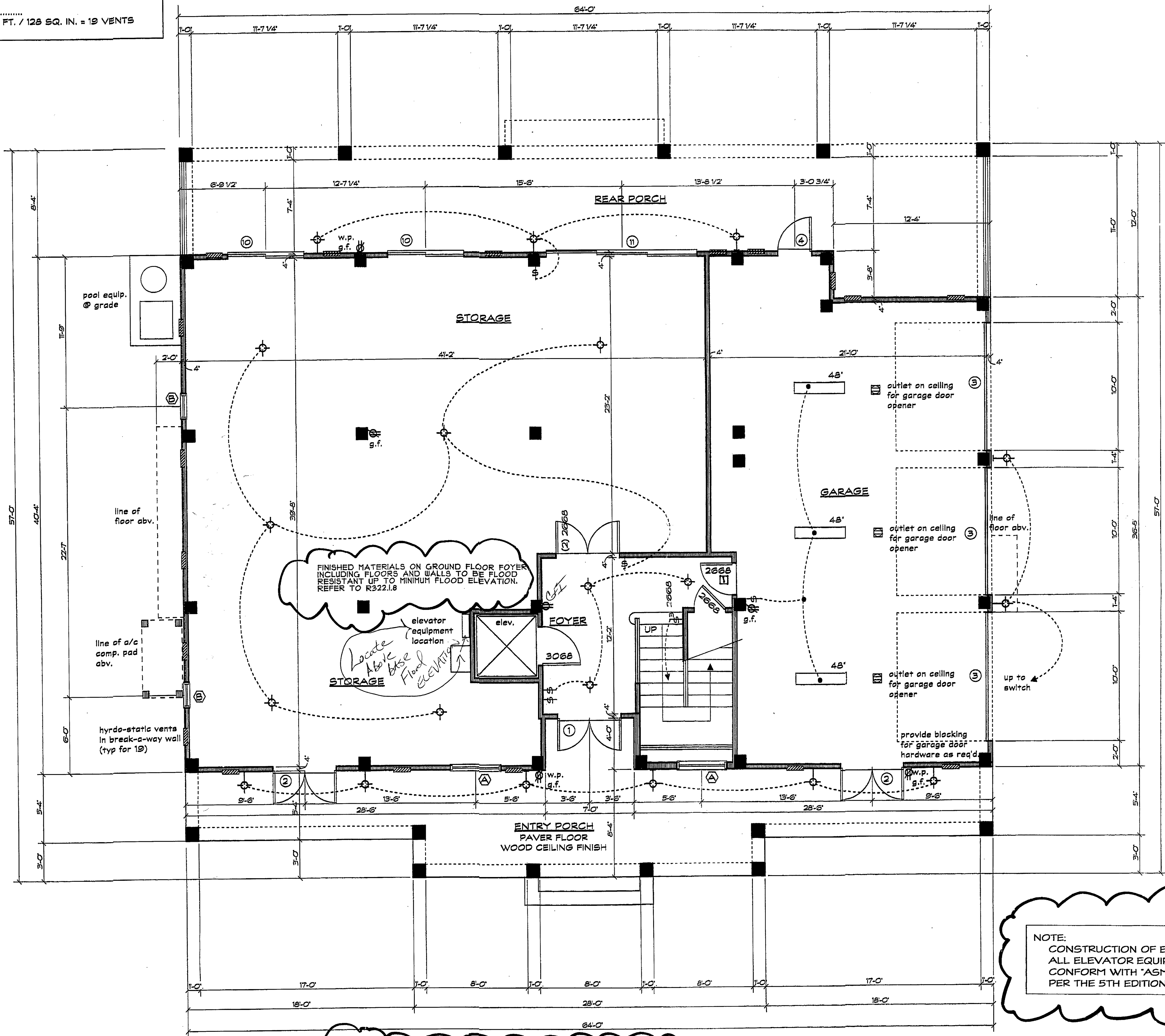

Reviewed For Code Compliance
 Sanibel Building Dept.

NOTE:
 CONSTRUCTION OF ELEVATOR AND ALL ELEVATOR EQUIPMENT SHALL CONFORM WITH ASME A 17.1 PER THE 5TH EDITION 'FBCR.'

THIS PLAN HAS BEEN REVIEWED, ENGINEERED AND SUPERVISED BY:
J.C. KOSINSKI ENGINEERING, INC.
 JOSEPH C. KOSINSKI, P.E.
 FL. REG. #22228
 FT. MYERS BEACH, FLORIDA 33931
 (239) 672-3179 JCKOSINSKI@att.net
 STRUCTURAL ONLY

1 R302.5.1 OPENING PROTECTION. OPENINGS FROM A PRIVATE GARAGE DIRECTLY INTO A ROOM USED FOR SLEEPING PURPOSES SHALL NOT BE PERMITTED. OTHER OPENINGS BETWEEN THE GARAGE AND RESIDENCE SHALL BE EQUIPPED WITH SOLID WOOD DOORS NOT LESS THAN 1 3/8 INCHES (35 MM) IN THICKNESS, SOLID OR HONEYCOMB-CORE STEEL DOORS NOT LESS THAN 1 3/8 INCHES (35 MM) THICK, OR 20-MINUTE FIRE-RATED DOORS, EQUIPPED WITH A SELF-CLOSING DEVICE.

NOTE: ALL ELECTRICAL OUTLETS AND FIXTURES TO BE ABOVE MIN. FLOOD ELEVATION
 ALL EXTERIOR LIGHTING FIXTURES TO MEET ALL REQUIRED 'DARK-SKY' ORDINANCES.

GROUND FLOOR PLAN

SCALE: 1/4" = 1'-0"

SHEET
A - 4
 MAY 1 2017