

Prepared by Stanley K. Ink,
Registered Land Surveyor
2247 Fowler Street
Fort Myers, Florida 33901

SANIBEL ARMS, A CONDOMINIUM

SANIBEL, FLORIDA

SURVEYOR'S CERTIFICATE

I, STANLEY K. INK, Registered Florida Land Surveyor, hereby certify that construction of improvements on Lots 122, 123 and 124, First Addition to Shell Harbor, Plat Book 25, Page 66, Public Records of Lee County, Florida, and shown on Exhibit "B" of Declaration of Condominium of Sanibel Arms, as Buildings "A", "B" and "C", as recorded in Condominium Plat Book 2, Page 76, Public Records, of Lee County, Florida, and also in O. R. Book 682, Page 737, said Public Records, have been completed and that the buildings and other improvements were constructed in basic accordance with the plot plan above referred to as Exhibit "B" as prepared by myself and as revised by the attached drawing. Such portion of Exhibit "B" as relates to Buildings "A", "B" and "C" and as revised by the attached drawing, together with the wording of the Declaration of Condominium is a correct presentation of the improvements described and that there can be determined therefrom the identification, location, dimension and size of the common elements and of each unit in said buildings.

DATED this 15TH day of June, 1971.

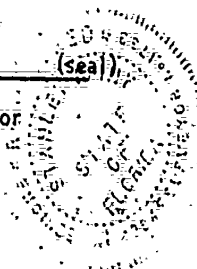
Stanley K. Ink
Stanley K. Ink
Registered Land Surveyor

STATE OF FLORIDA
COUNTY OF LEE

Before me, the undersigned authority, personally appeared
STANLEY K. INK to me known and who acknowledged that he executed the fore-
going instrument for the purposes therein mentioned.
WITNESS my hand and official seal this 15 day of June, 1971.

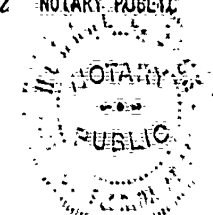
Howard S. Brady
NOTARY PUBLIC

MY COMMISSION EXPIRES:
My Commission Expires July 27, 1973

AS BUILT SURVEY
LOTS 122, 123 & 124 FIRST
ADDITION TO SHELL HARBOR
PB 25 PAGE 66 PUBLIC
RECORDS OF LEE COUNTY
FLORIDA.

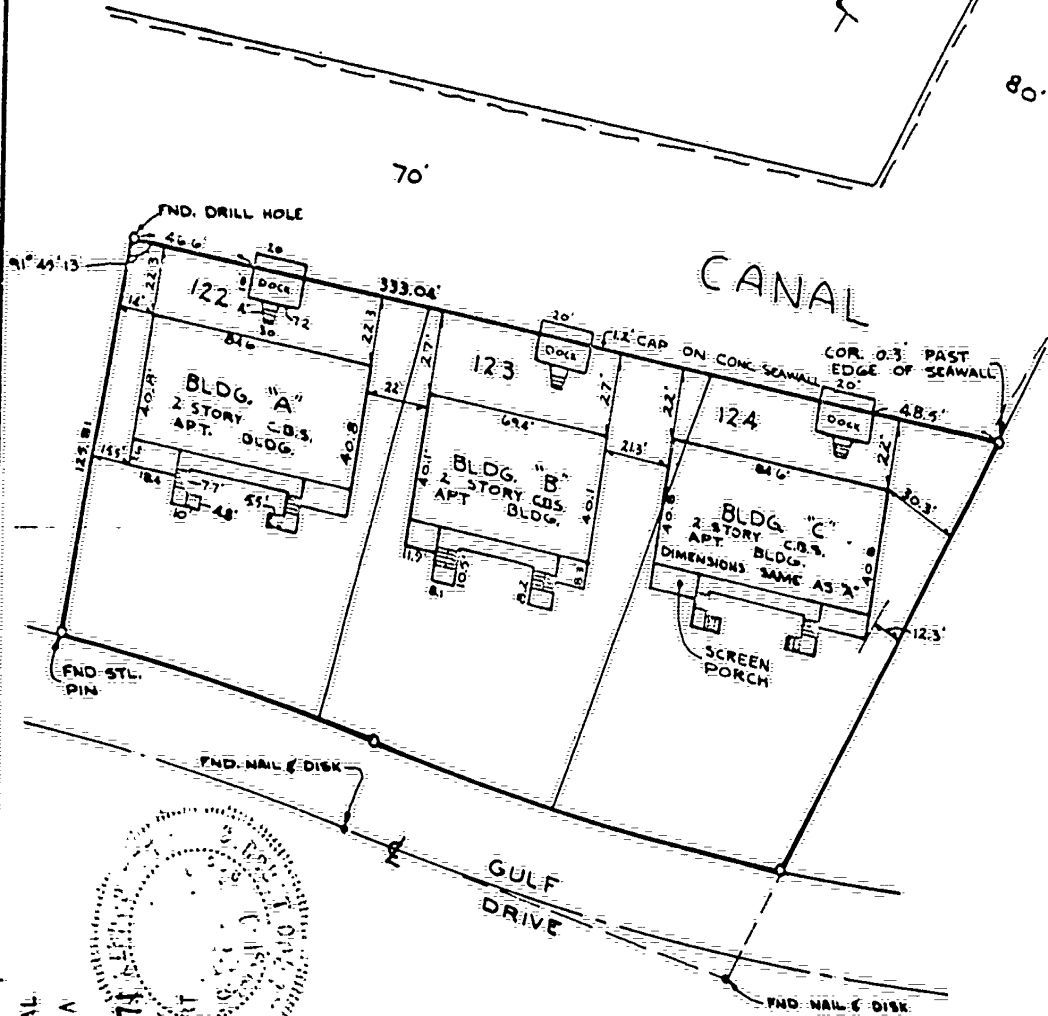

RECORDS SECTION
LEE COUNTY FLORIDA
JUN 16 3 56 PM '71
D. J. ...
Information

NOTE:
SEE SANIBEL ARMS, A CONDOMINIUM
C.P.B. 2 PAGE 76 FOR DETAILS
NOT SHOWN.

I HEREBY CERTIFY THAT THIS PLAT IS A TRUE
REPRESENTATION OF THE LAND SHOWN & DESCRIBED
HEREWITH, TO THE BEST OF MY KNOWLEDGE,
ACCORDING TO A RECENT SURVEY MADE UNDER
MY DIRECTION.

STANLEY K. INK
REG. LAND SURVEYOR
FLA. CERTIFICATE 1733

JOB NO: 1818-A
DATE: 15 JUNE 1971
SCALE: 1" = 50'

INK ENGINEERING, INC
2247 FOWLER ST FORT MYERS FLORIDA