

SALE PACKAGE



29-35 School Street
Acton, MA 01720

REGION
COMMERCIAL

Contact

Mitch Bolotin

P: 413-415-1200

C: 413-537-2020

E: mitch@regionco.com

LIC (MA): 134459

REGION CO LLC

Ben Bolotin

P: 978-540-0029

C: 413-530-3215

E: ben@regionco.com

LIC (MA): 9582125

REGION CO LLC

REGION
COMMERCIAL

DISCLAIMER

The information contained in the following Marketing Brochure is proprietary and strictly confidential. It is intended to be reviewed only by the party receiving it from REGION CO LLC (d/b/a "Region Commercial") and should not be made available to any other person or entity without the written consent of REGION CO LLC. This Marketing Brochure has been prepared to provide summary, unverified, information and the information contained herein is not a substitute for a thorough investigation of all considerations concerning the purchase or sale of the Subject Property. By reviewing this document it is expressly understood that all parties should conduct their own independent analysis. REGION CO LLC has not made any investigation, and makes no warranty or representation, with respect to the income or expenses for the subject property, the future projected financial performance of the property, the size and square footage of the property and improvements, the presence or absence of contaminating substances, PCB's or asbestos, the compliance with State and Federal regulations, the physical condition of the improvements thereon, or the financial condition or business prospects of any tenant, or any tenant's plans or intentions to continue its occupancy of the subject property. Buyers must verify the information and bears all risk for any inaccuracies.

REGION CO LLC is not affiliated with, sponsored by, or endorsed by any commercial tenant or lessee identified in this marketing package. The presence of any corporation's logo or name is not intended to indicate or imply affiliation with, or sponsorship or endorsement by, said corporation of REGION CO LLC, its affiliates or subsidiaries, or any agent, product, service, or commercial listing of REGION CO LLC, and is solely included for the purpose of providing tenant lessee information about this listing to prospective Buyers. REGION CO LLC is a Massachusetts Limited Liability Company ("LLC"). All rights reserved.

SUMMARY

Region Commercial Real Estate is pleased to present on an exclusive basis this approximately 7,101 square foot church property, located on School Street in Acton, MA.

This beautiful, historic, building features a large vaulted sanctuary space, able to accommodate roughly 100 people. The large meeting area is able to be combined with the sanctuary through large sliding doors, or kept separate as a gathering space. Private offices, meeting rooms, and a kitchenette can be found off this large meeting area, including a handicap-accessible lift for access to the finished lower level. Downstairs includes bathrooms, more open meeting space, a nursery, additional meeting and storage rooms, utility closets, as well as a full kitchen. The nearby town parking lot consists of roughly 23 parking spaces, and the parcel includes a deeded parking space as well.

Only a short, 4-minute, walk away is the South Acton commuter rail station, and 3-minutes to the North is Route 2, making this an extremely convenient, well located parcel with lots of potential. The property sits roughly equidistant to downtown West Acton, Maynard, Stow, and West Concord.

Please note: church artifacts and furniture are not included in the sale but may be available for purchase.





PLEASE NOTE:

Information provided here is based on records maintained by the city & town. All prospective buyers must conduct their own analysis to determine the subject property's suitability for their needs.

Total Acreage	0.39
Building Size (SF)	7,101
Sewer Assessment	\$242/quarter
Year Built	1891
Stories	2
Foundation	Field Stone
Heat	Gas fired boiler 2000 high efficiency Energy Kinetics, baseboard hot water system
AC	Window Units, Fans
Sprinklers	No
Roof	Asphalt Shingles c. 2006
Kitchen	Yes - ADA compliant with commercial dish sterilizer

Parking	1 off-street, 5 at the curb, 23 public parking lot
Bathroom(s)	Two (M/W) Downstairs
Water	Municipal
Sewer	Municipal
Gas	National Grid
Electric	Eversource (200 Amps)
Internet	Verizon Fios
Zoning	SAV
Frontage	87'
Taxes	Exempt, \$242/quarter sewer assesment
Eversource Bill	\$157.52 (April 24)
National Grid Bill	\$727.84 (Jan 2019)

Street Level

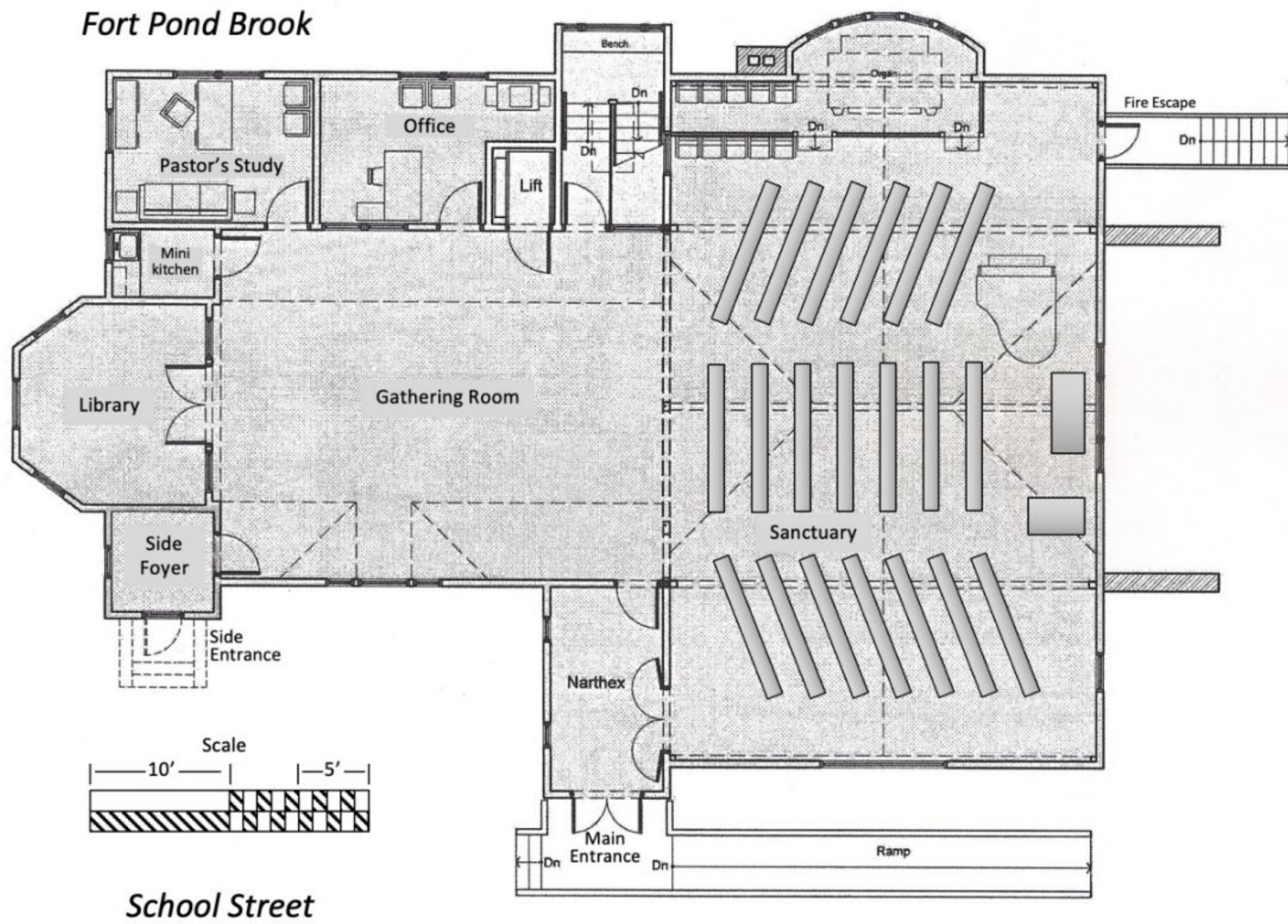

Lower Level

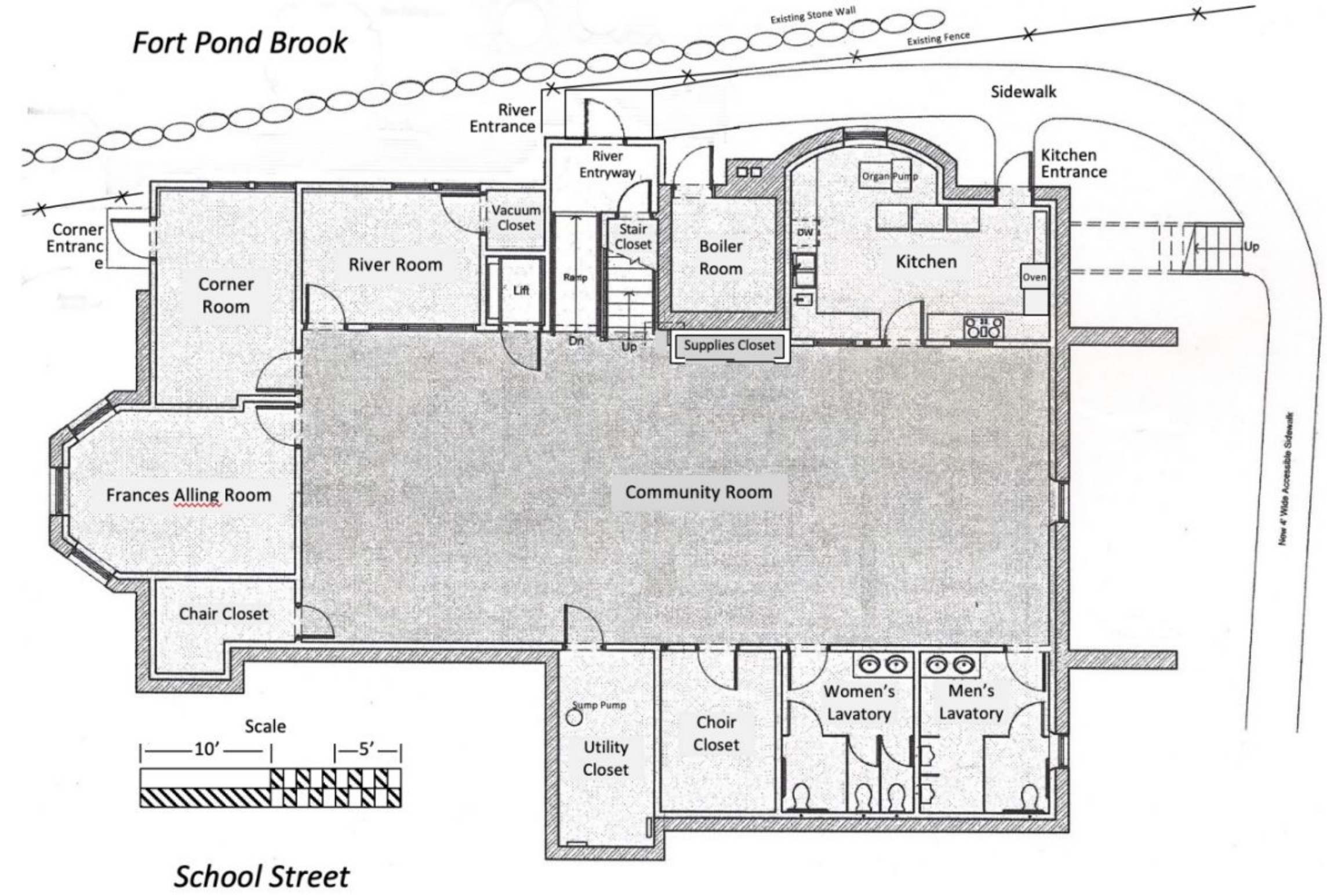

REGION

COMMERCIAL

29-35 School Street is located in close proximity to surrounding towns and neighborhoods. Route 2 and Interstate 495 are also just a short drive away for access into Boston or Central Mass.

LOCATION

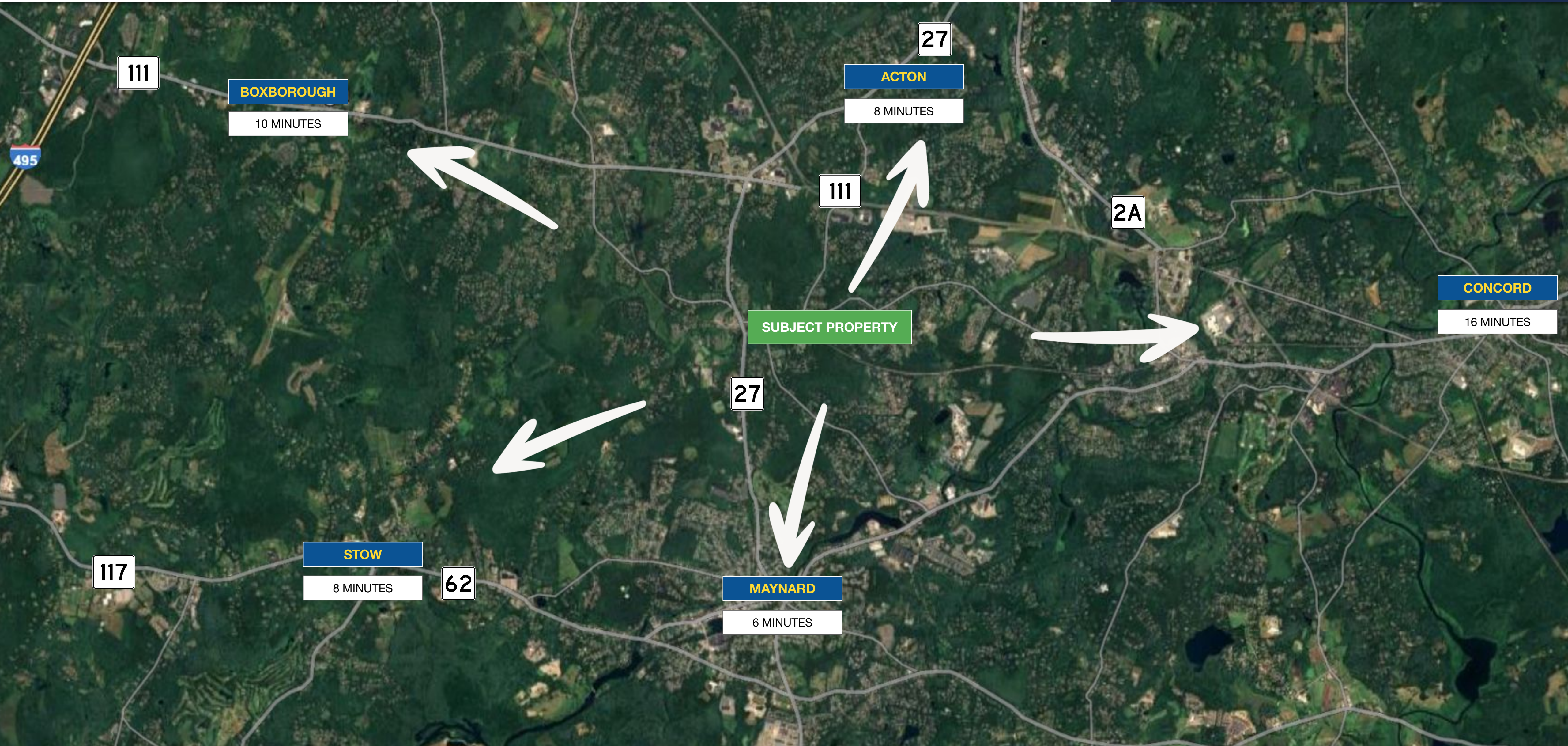





REGION
COMMERCIAL



REGION
COMMERCIAL



REGION

COMMERCIAL





REGION

COMMERCIAL





REGION

COMMERCIAL





REGION

COMMERCIAL

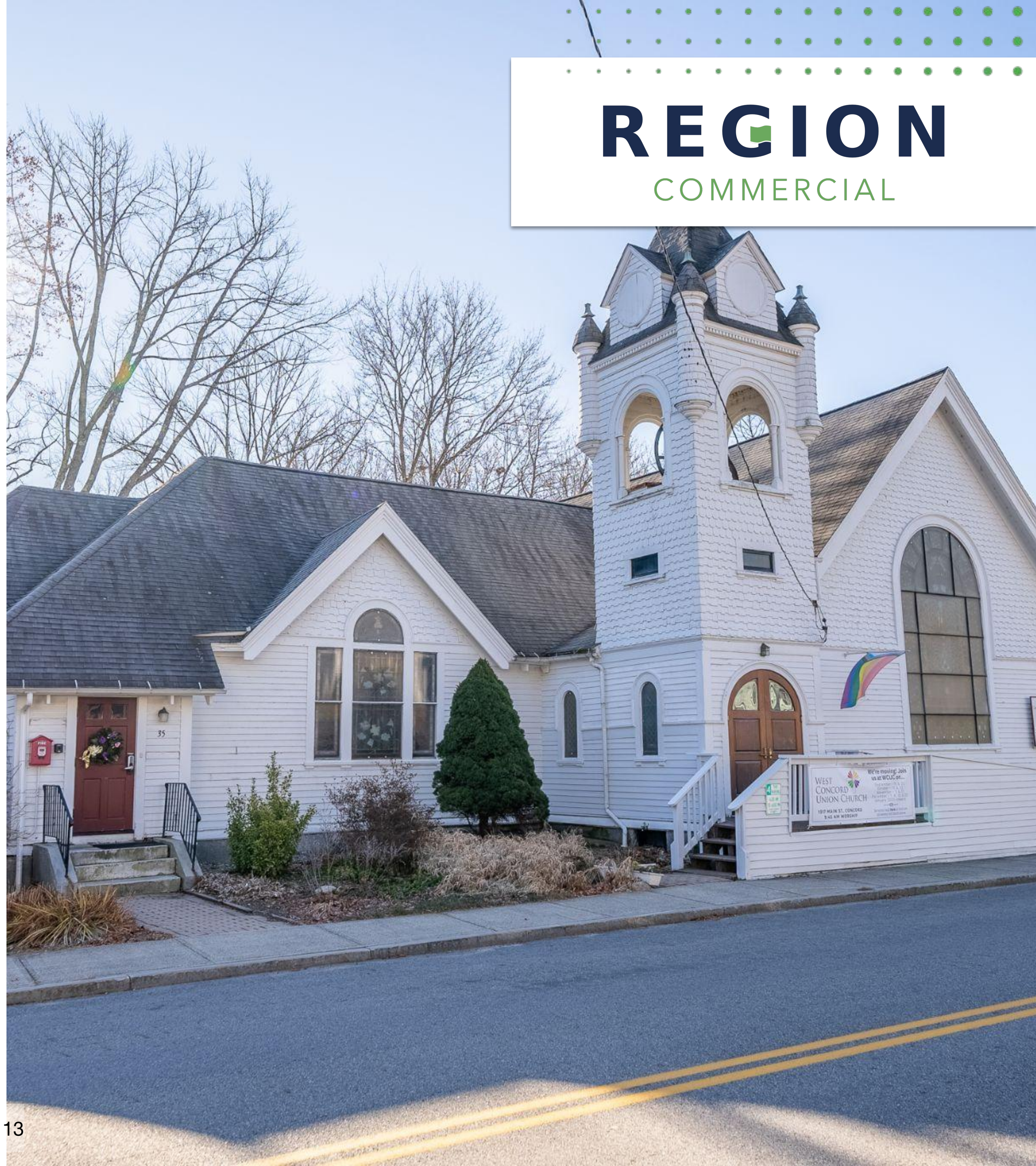

29-35 School Street

Acton, MA 01720

Contact

Mitch Bolotin

P: 413-415-1200

C: 413-537-2020

E: mitch@regionco.com

LIC (MA): 134459

REGION CO LLC

Ben Bolotin

P: 978-540-0029

C: 413-530-3215

E: ben@regionco.com

LIC (MA): 9582125

REGION CO LLC

REGION
COMMERCIAL